

# **INITIAL RECEIPT**

**United States Department of the Interior**  
**Bureau of Land Management**  
 DIV OF LANDS, MINRLS & ENERGY  
 ONE N CENTRAL AVE  
 PHOENIX, AZ 85004 -4427  
 Phone: 602-417-9200

|         |         |
|---------|---------|
| Receipt |         |
| No:     | 4726095 |

|                                                         |  |
|---------------------------------------------------------|--|
| Transaction #: 4851544                                  |  |
| Date of Transaction: 04/17/2020                         |  |
| CUSTOMER:                                               |  |
| GLENN WEBSTER<br>PO BOX 155<br>SALOME, AZ 85348-0155 US |  |

| LINE #        | QTY  | DESCRIPTION                                                                                                                                   | REMARKS | UNIT PRICE | TOTAL           |
|---------------|------|-----------------------------------------------------------------------------------------------------------------------------------------------|---------|------------|-----------------|
| 1             | 1.00 | LOCATABLE MINERALS / MINING CLAIMS-<br>NEW, UNADJUD, ONE OR MORE AUTH NOS /<br>NEW MINING CLAIM PROCESSING FEE<br>CASES: AMC459713/\$20.00    |         | - n/a -    | 20.00           |
| 2             | 1.00 | LOCATABLE MINERALS / MINING CLAIMS-<br>NEW, UNADJUD, ONE OR MORE AUTH NOS /<br>NEW MINING CLAIMS LOCATION FEE<br>CASES: AMC459713/\$40.00     |         | - n/a -    | 40.00           |
| 3             | 1.00 | LOCATABLE MINERALS / MINING CLAIMS-<br>NEW, UNADJUD, ONE OR MORE AUTH NOS /<br>NEW MINING CLAIMS MAINTENANCE FEE<br>CASES: AMC459713/\$165.00 |         | - n/a -    | 165.00          |
| <b>TOTAL:</b> |      |                                                                                                                                               |         |            | <b>\$225.00</b> |

| PAYMENT INFORMATION |           |                                                         |                      |
|---------------------|-----------|---------------------------------------------------------|----------------------|
| 1                   | AMOUNT:   | 10.00                                                   | POSTMARKED: N/A      |
|                     | TYPE:     | CHECK                                                   | RECEIVED: 04/09/2020 |
|                     | CHECK NO: | 6361                                                    |                      |
|                     | NAME:     | WEBSTER, GLENN<br>PO BOX 155<br>SALOME AZ 85348-0155 US |                      |
| 2                   | AMOUNT:   | 215.00                                                  | POSTMARKED: N/A      |
|                     | TYPE:     | CHECK                                                   | RECEIVED: 04/17/2020 |
|                     | CHECK NO: | 6362                                                    |                      |
|                     | NAME:     |                                                         |                      |

**ENTERED**  
**APR 22 2020**  
 BY: *Rtm*

|  |  |                                                         |
|--|--|---------------------------------------------------------|
|  |  | WEBSTER, GLENN<br>PO BOX 155<br>SALOME AZ 85348-0155 US |
|--|--|---------------------------------------------------------|

|         |
|---------|
| REMARKS |
|         |

This receipt was generated by the automated BLM Collections and Billing System and is a paper representation of a portion of the official electronic record contained therein.

APR 18 2020

# **CORRESPONDENCE**

# **TRANSFERS**

**MAINTENANCE FEES**  
**WAIVERS**  
**POL/NOI**

# **MISCELLANEOUS**

Tina

Please put the name on the claim as the " D and G Wildcat Claim "

Thanks Glenn .....

RECEIVED  
DEPARTMENT STATE OFFICE  
2020 APR 15 P 1:27  
PHOENIX, ARIZONA

AMC459713



Lat Long  
1 = 33.66112 -113.59894

2 = 33.66099 -113.59768

3 = 33.65837 -113.59922

4 = 33.65837 -113.60036

RECEIVED  
BIMAJ STATE OFFICE  
2020 APR -9 A 8:33  
PHOENIX, ARIZONA

AMCL59713

**LOCATION NOTICES  
AMENDMENTS  
STATUS SHEET  
GEO REPORT/MTP**

# MINING CLAIM STATUS REPORT - Assessment Year 2020

Data Entered: 4/22/2020

MTP Checked By: 4/22/2020  
 GEO Checked By: 4/22/2020

LEAD SERIAL NUMBER: AMC 459713 thru AMC \_\_\_\_\_

**NUMBER OF CLAIMS & TYPE:**

\_\_\_\_ LODE  
1 PLACER  
 \_\_\_\_ ASSOCIATION PLACER  
 \_\_\_\_ MILL SITE  
 \_\_\_\_ TUNNEL SITE

**CHARGES:**

Processing Fee @ \$20 = \$ 20  
 Location Fee @ \$40 = \$ 40  
 Maintenance Fee @ \$165 = \$ 165  
 Add'l Maint Fee for Assoc Placer = \$ \_\_\_\_\_  
**SUBTOTAL** \$ \_\_\_\_\_  
 Other Fees \$ \_\_\_\_\_  
 Other Fees \$ \_\_\_\_\_  
**TOTAL** \$ 225

**TOTAL ACREAGE:** \_\_\_\_\_ Per Claim  
 (Placer Only)

**NUMBER OF LOCATORS:** \_\_\_\_\_

**DOCUMENTS RECEIVED VIA:** Over-the-Counter [ ] Mail [  ] **TIMELY FILED:** Yes [  ] No [ ]

**LEGAL DESCRIPTION:** T 4N R 13W SEC 28  
 T \_\_\_\_\_ R \_\_\_\_\_ SEC \_\_\_\_\_  
 T \_\_\_\_\_ R \_\_\_\_\_ SEC \_\_\_\_\_  
 T \_\_\_\_\_ R \_\_\_\_\_ SEC \_\_\_\_\_  
 T \_\_\_\_\_ R \_\_\_\_\_ SEC \_\_\_\_\_

BLM [ ] FOREST SERVICE [ ] \_\_\_\_\_ SUBJ TO PL 359: Yes [ ] No [ ]  
 WILDERNESS AREA [ ] \_\_\_\_\_

**SPLIT ESTATE:** N/A [ ] SX [ ] PX [ ] OTHER [ ] \_\_\_\_\_  
 SRHA [ ] Was proper Notice filed if located on SHRA Land? Yes [ ] No [ ]

**RECONVEYED MINERALS ON BLM LAND REQUIRE OPENING ORDER FROM 1944 TO 1993:**  
 Open to Entry On \_\_\_\_\_ N/A [ ]

**COMMENTS/STATUS:** VOID [ ] PARTIALLY VOID [ ] PVT MINERALS [ ] WITHDRAWN LANDS [ ]  
 OTHER [ ] \_\_\_\_\_

[ ] Claimant acknowledges that portions of the following claim(s) site(s) may be void or voidable.

Printed Name of Claimant \_\_\_\_\_ Signature of Claimant \_\_\_\_\_

\*\*\*\*\*FINAL ADJUDICATION\*\*\*\*\*

DATE \_\_\_\_\_ INITIALS \_\_\_\_\_

AMC459713

# COPY

**LOCATION NOTICE FOR PLACER MINING CLAIM**

Amendment BLM Serial # \_\_\_\_\_ D and G Wildcat claim

NOTICE IS HEREBY GIVEN that the GLENN WEBSTER

DAVID EEDS placer mining claim has been located by GLENN WEBSTER / DAVID EEDS whose current mailing address is P.O. BOX 155 SALOME AZ

RECEIVED  
BLM AZ STATE OFFICE  
2020 APR - 9 A 8:33  
PHOENIX, ARIZONA

BLM  
Date  
Stamp

85348 / PO BOX 759 SALOME AZ 85348

The general course of this claim is for minerals and it is situated in LA PAZ CO County, Arizona. This claim is 1300 feet in length and 365 feet in width.

10.90 Total Claim Acreage. This claim runs from the location monument on which this location notice is posted at the NW corner of the claim approximately 1300 feet in a SOUTH direction to the W/E end line and 365 feet in a East direction to the N/S end line. This claim is marked by four monuments, one at each corner of the claim.

The location monument on which this notice is posted is situated within Section 28, Township 4 North, Range 13 West, Gila Salt River Base and Meridian, Arizona. This claim encompasses

portions of the following legal subdivision(s) if located by legal subdivision or the following quarter section(s), section(s), Township(s) and Range(s) N 1/2 NW 1/4 SE 1/4, NW 1/4 NE 1/4 SE 1/4, SE 1/4 SW 1/4 NE 1/4, SW 1/4 SE 1/4 NE 1/4, Gila Salt River Base and Meridian, Arizona.

The locality of this claim with reference to some natural object or permanent monument and additional information (if any) concerning its locality are as follows: This claim is the former Evan and Stacey White Marble mine.

\_\_\_\_\_ The above information is shown on the attached map.

DATED AND POSTED on the ground this 4<sup>th</sup> day of April, 2020.

LOCATOR(s)  AGENT

Print Name(s) DAVID EEDS GLENN WEBSTER

Signature(s) David E Gl Webster

Form MCF102  
Revised July 2014

AMC459713

**MINING CLAIM MAP**

Lode ( ) Placer (✓)  
Millsite ( )

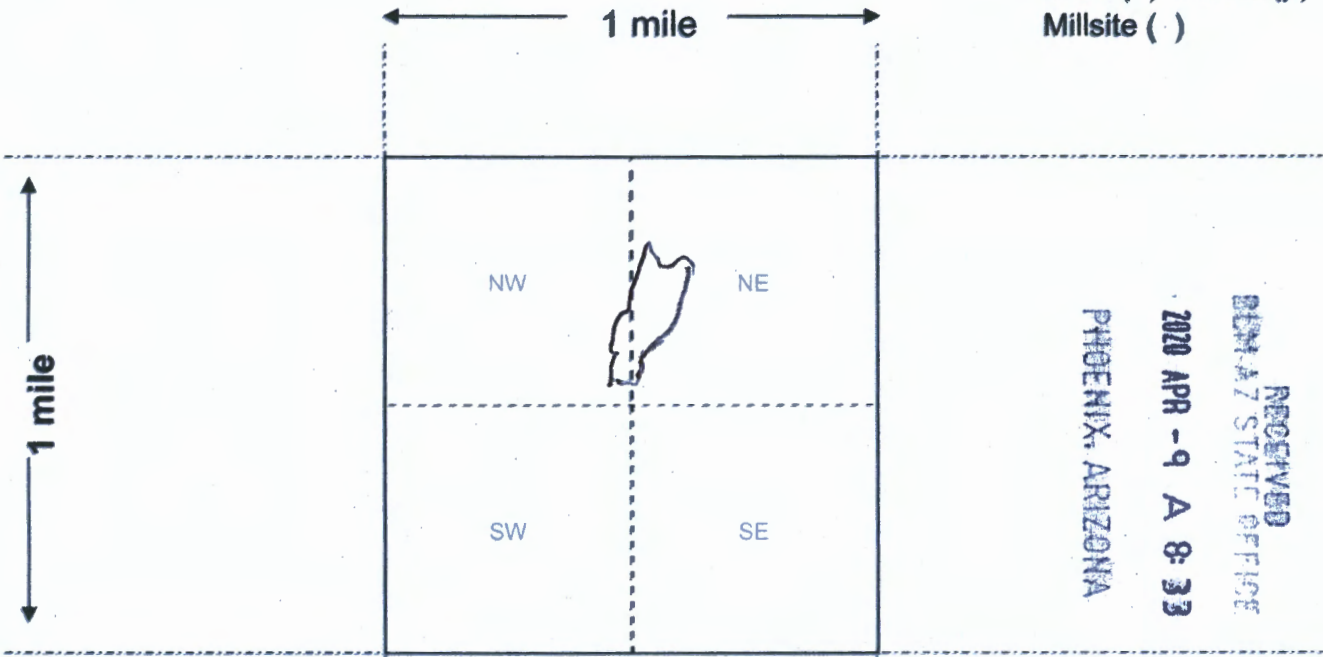

RECEIVED  
 DENA 47 STATE OFFICE  
 2020 APR - 9 A 8:33  
 PHOENIX, ARIZONA

Scale: 1" = 2000 feet



- The above map depicts the GLENN WEBSTER mining claim, which is located in Section (s) 28, Township 4 North, Range 13 West, Gila and Salt River Base and Meridian, La Paz County, Arizona. Total claim acreage is \_\_\_\_\_
- The type of corner and location monuments used are as follows: 3ft tall wooden stakes, painted red.
- The bearings and distances in degrees and feet between claim corners and to a public land survey monument are as depicted on the map. (2 maps attached,
- If the claim is a placer or millsite claim with exterior limits conforming to legal subdivisions of the public survey, provide a legal description of the claim \_\_\_\_\_

See attached maps.

Form MCF100a  
Revised July 2014

AMC459713

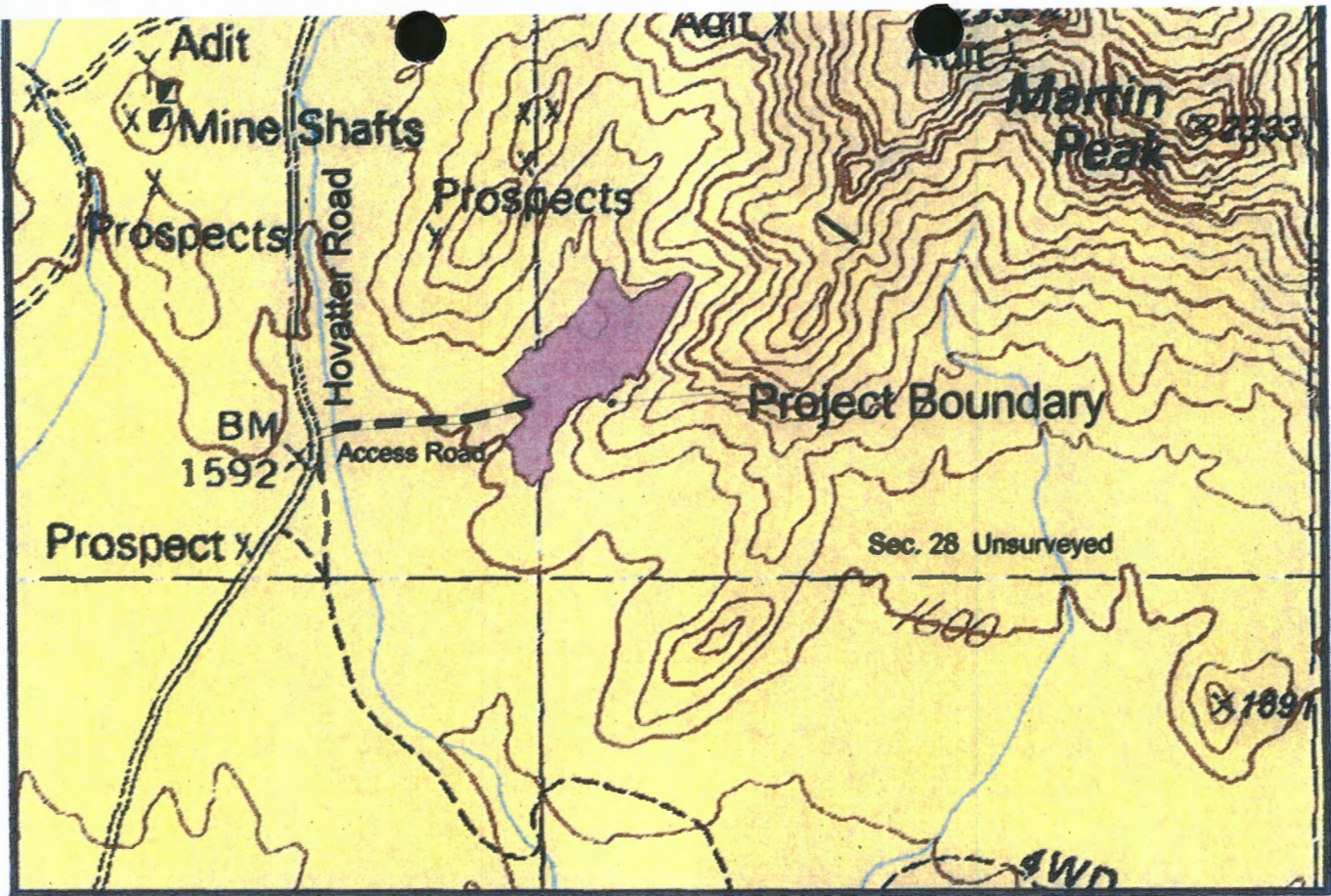

1000 0 1000 2000 Feet

Harrisburg Valley Topo Map  
T4N, R13W

## Legend

-  Mineral Material Site Location
-  Access Road
- Land Ownership**
-  Bureau of Land Management
-  Private Land



AMC459713

RECEIVED  
 BLM AZ STATE OFFICE  
 2020 APR - 9 A 8:38  
 PHOENIX, ARIZONA

# ArcGIS Web Map



April 4, 2020

- LaPaz\_Boundary
- Streets

RECEIVED  
BIRMINGHAM STATE OFFICE  
2020 APR - 9 8 33

PHOENIX, ARIZONA

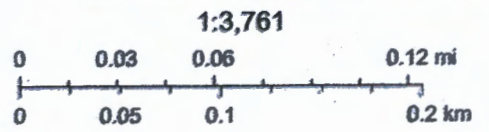

Source: Esri, DigitalGlobe, GeoEye, Earthstar Geographics, CNES/Airbus DS, USDA, USGS, AeroGRID, IGN, and the GIS User Community

Date and Time Run:  
4/22/2020 4:15:28 PM

Page 1 of 1

DEPARTMENT OF THE INTERIOR  
BUREAU OF LAND MANAGEMENT  
Case Recordation

Geographic Report with Land

Disposition is equal to **AUTHORIZED , CANCELLED , EXPIRED , PENDING , REJECTED , RELINQUISHED ,  
WITHDRAWN**

and Meridian Township Range Section is equal to **14 0040N 0130W 028**

and Admin State is equal to **AZ**

NO WARRANTY IS MADE BY BLM  
FOR USE OF THE DATA FOR  
PURPOSES NOT INTENDED BY BLM



DEPARTMENT OF THE INTERIOR  
BUREAU OF LAND MANAGEMENT  
Case Recordation  
Geographic Report with Land

Admin State: AZ  
Geo State: AZ

| Serial Number | Total Case Acres: | Case type | Case Disp  | Mer | Twp   | Rng   | Sec | Sur Type | Sur Nr | Suf | Subdivision                                           | Act/Pend |
|---------------|-------------------|-----------|------------|-----|-------|-------|-----|----------|--------|-----|-------------------------------------------------------|----------|
| AZA 034939    | 7.250             | 361113    | EXPIRED    | 14  | 0040N | 0130W | 028 | PROT     |        |     | N2NWSE,NWNESE,<br>SESWNE;<br>SWSENE;                  |          |
|               | 7.250             |           |            |     |       |       |     |          |        |     |                                                       |          |
| AZA 036858    | 84.200            | 281001    | AUTHORIZED |     |       |       |     | ALIQ     |        |     | NWNENE,NWNE,<br>W2SWNW;<br>W2NWSE,SENESEW,<br>E2SESW; |          |
|               | 84.200            |           |            |     |       |       |     |          |        |     |                                                       |          |
| AZA 037929    | 55.000            | 380910    | PENDING    |     |       |       |     | ALL      |        |     | ENTIRE SECTION                                        |          |
| AZA 037983    | 1.000             | 361113    | AUTHORIZED |     |       |       |     | FF       |        |     | NWSE; NESE                                            |          |

# UNSURVEYED TOWNSHIP 4 NORTH RANGE 13 WEST OF THE GILA AND SALT RIVER MERIDIAN, ARIZONA

PROTRACTION DIAGRAM NO 19 OFFICIALLY FILED 12/07/1959

LA PAZ COUNTY  
LAKE HAWES FIELD OFFICE

T 5N  
R 13W R 12W

STATUS OF PUBLIC DOMAIN  
LAND AND MINERAL TITLES



| INDEX TO SEGREGATED TRACTS |                 |   |     |             |
|----------------------------|-----------------|---|-----|-------------|
| TRACT NO                   | ORIGINAL SURVEY |   |     |             |
|                            | T               | R | SEC | SUBDIVISION |
|                            |                 |   |     |             |
|                            |                 |   |     |             |
|                            |                 |   |     |             |
|                            |                 |   |     |             |
|                            |                 |   |     |             |
|                            |                 |   |     |             |
|                            |                 |   |     |             |
|                            |                 |   |     |             |
|                            |                 |   |     |             |

FOR ORDERS AFFECTING DISPOSAL OR USE OF UNIDENTIFIED LANDS WITHDRAWN FOR CLASSIFICATION, MINERALS, WATER AND/OR OTHER PUBLIC PURPOSES, REFER TO INDEX OF MISCELLANEOUS DOCUMENTS.

Grazing Dist No 3  
MDS 364 NE  
365 NW  
366 SE

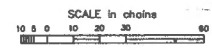

**WARNING STATEMENT**  
This plot is the Bureau's Record of Title and should be used only as a graphic display of the township survey data. Recorders herein do not reflect title changes which may have been affected by lateral movements of rivers or other bodies of water. Refer to the associated surveys for official survey information.

|            |      |         |
|------------|------|---------|
| CURRENT TO | LT   | GSR Mer |
| 3-28-2016  | ACAD | T 4 N   |
|            |      | R 13 W  |

GLENN WEBSTER  
P.O. BOX 155  
SA LOME  
AZ 85348

PHOENIX AZ 857  
07 APR 2020 PM 9 L



FOREVER 7 USA

RECEIVED  
BEM AZ STATE OFFICE  
2020 APR -9 A 8:07  
PHOENIX, ARIZONA

BLM - AZ:O  
1 N. Central Ave  
Suite 800  
Phoenix  
AZ 85004  
85004-857004

ATTN: - Account



Glenn Webster  
P.O. Box 155  
Salome  
AZ 85348

BLM - AZSO  
1 N Central Ave.  
Suite 800  
Phoenix

AZ 85004  
85004-442700



PHOENIX, AZ 85004

10 APR 2020 PM 8:11

FOREVER / USA

RECEIVED  
BLM-AZ STATE OFFICE

2020 APR 15 P 1:27

PHOENIX, ARIZONA

Attn

T. J. [unclear]

